



# Oil Filter Relocation Kit

For Yamaha 1100 V-Star Motorcycles

## Model Number YVS-C

(OF-0080)

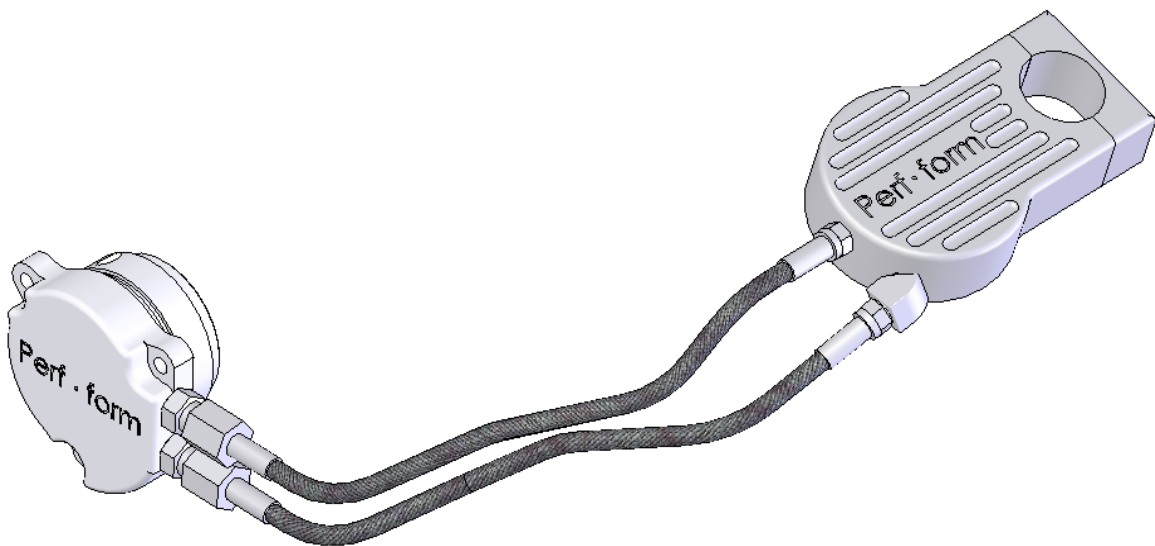

The Yamaha V-Star Oil Filter Relocation Kit provides an alternate location for your oil filter that eliminates the need to remove your exhaust system when changing your oil filter.

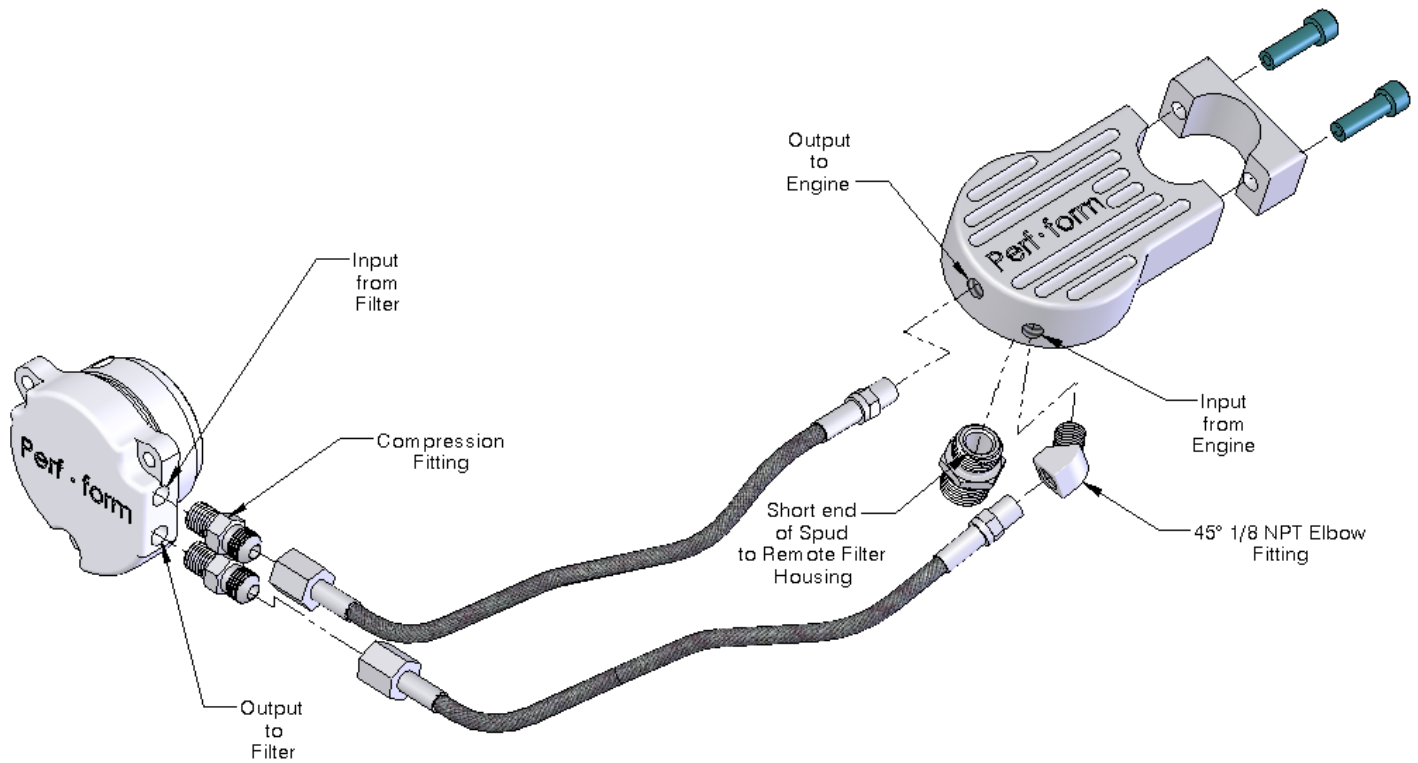

## **Parts List**

- |   |           |
|---|-----------|
| 1) Filter Plate Adapter (motorcycle side) | (PUR0804) |
| 1) Remote filter mount /frame clamp       | (PUR0803) |
| 2) 5/16" x 1" Stainless Allen head screw  | (PUR1213) |
| 1) Oil Filter Spud                        | (PUR0802) |
| 2) 13" braided stainless oil lines        | (PUR2072) |
| 4) Compression oil line fitting/adapters  | (PUR2074) |
| 1) 45° 1/8 NPT fitting                    | (PUR2073) |

### **Installation:**

1. Remove the four bolts that attach the right foot peg and foot brake assembly. Disconnect the electrical connection for the brake light. Leave the brake fluid reservoir hose connected.
2. Loosen and remove the muffler assembly from the motorcycle. Loosen the manifold nuts for the lower exhaust pipe (front cylinder) and remove it.

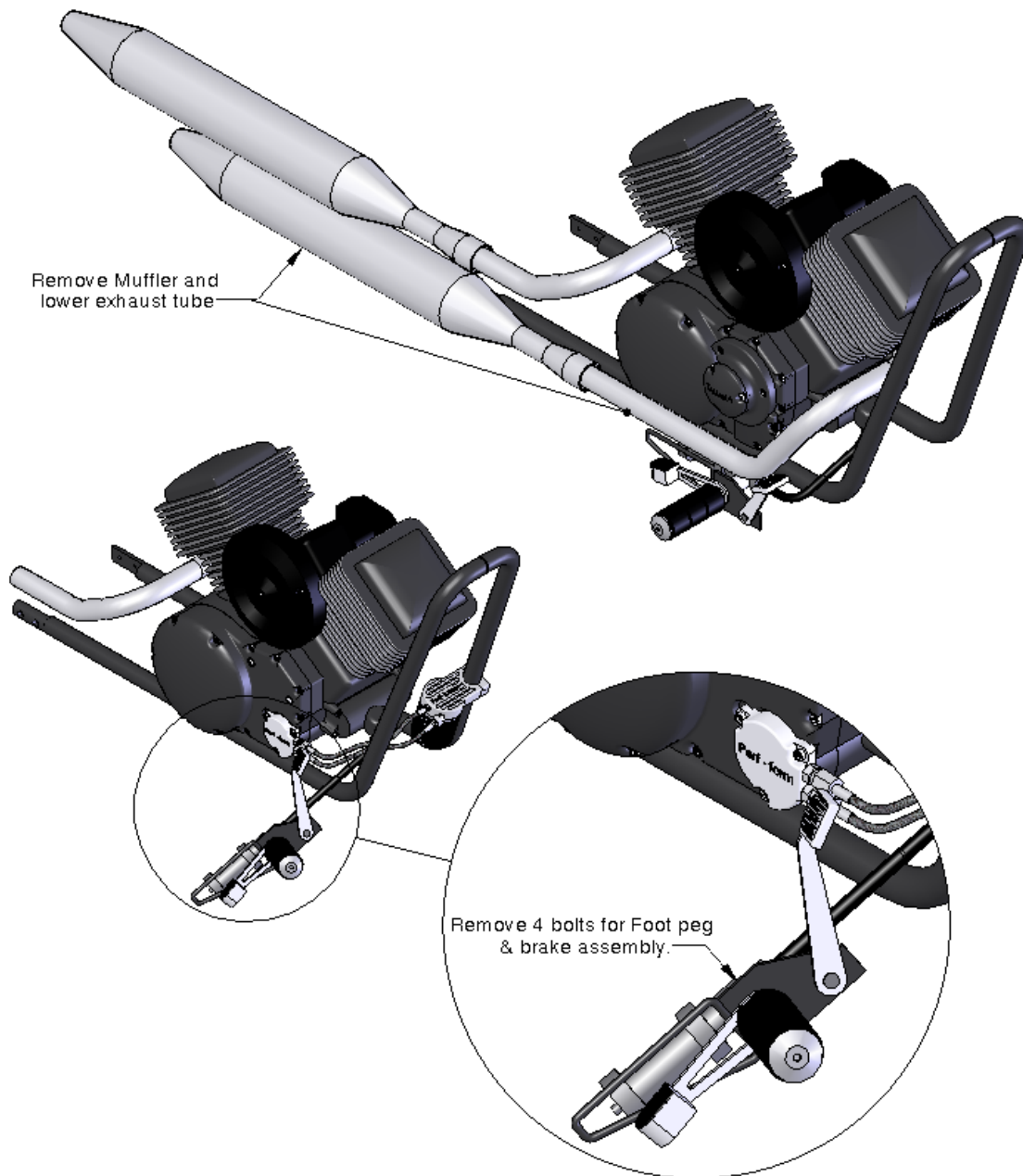

3. Remove the five bolts that secure the beauty cover to the motor case and remove the cover.
  - a. Save the screws, some will be reused.
4. Remove the oil filter cap and the oil filter. Be aware that the bottom bolt hole has an O-ring. Do not lose or damage this O-ring. Remove the two O-rings from the filter cap with an O-ring pick and inspect them. Replace them if there is any damage or signs of wear.
  - a. Save the screws, some will be reused with this kit.

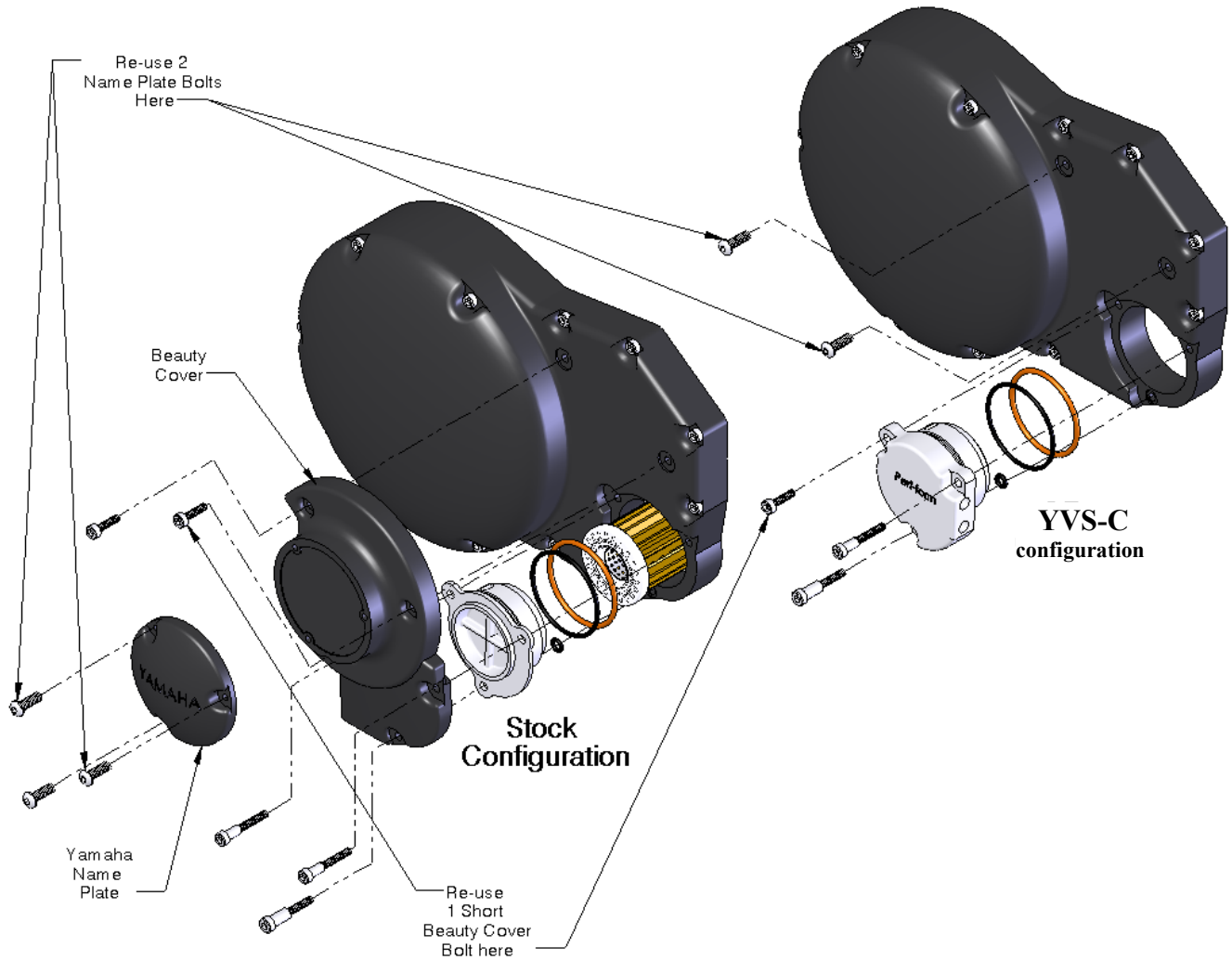

5. Lightly grease the O-rings and install them into their respective locations on the filter plate adapter as shown below.
6. Insert the filter plate adapter carefully into the filter housing to prevent damage to the O-rings.
7. Install the bolts for the filter plate adapter. The bottom bolt location of the filter housing requires a different bolt than all the others. This bolt has a larger head and collar diameter. The top rear bolt hole of the filter adapter will now use one of the short 6x20mm bolts removed from the beauty cover. There are two remaining holes on the motor casing left empty from the removal of the beauty cover. Use two of the bolts from the “Yamaha” cap to fill these locations. Use a thread lock compound such as Loctite® Blue Threadlocker 243. Evenly tighten the bolts on the filter adapter with quarter turns, until tight. Finish tightening the filter plate adaptor bolts to 7.2 ft-lb each.

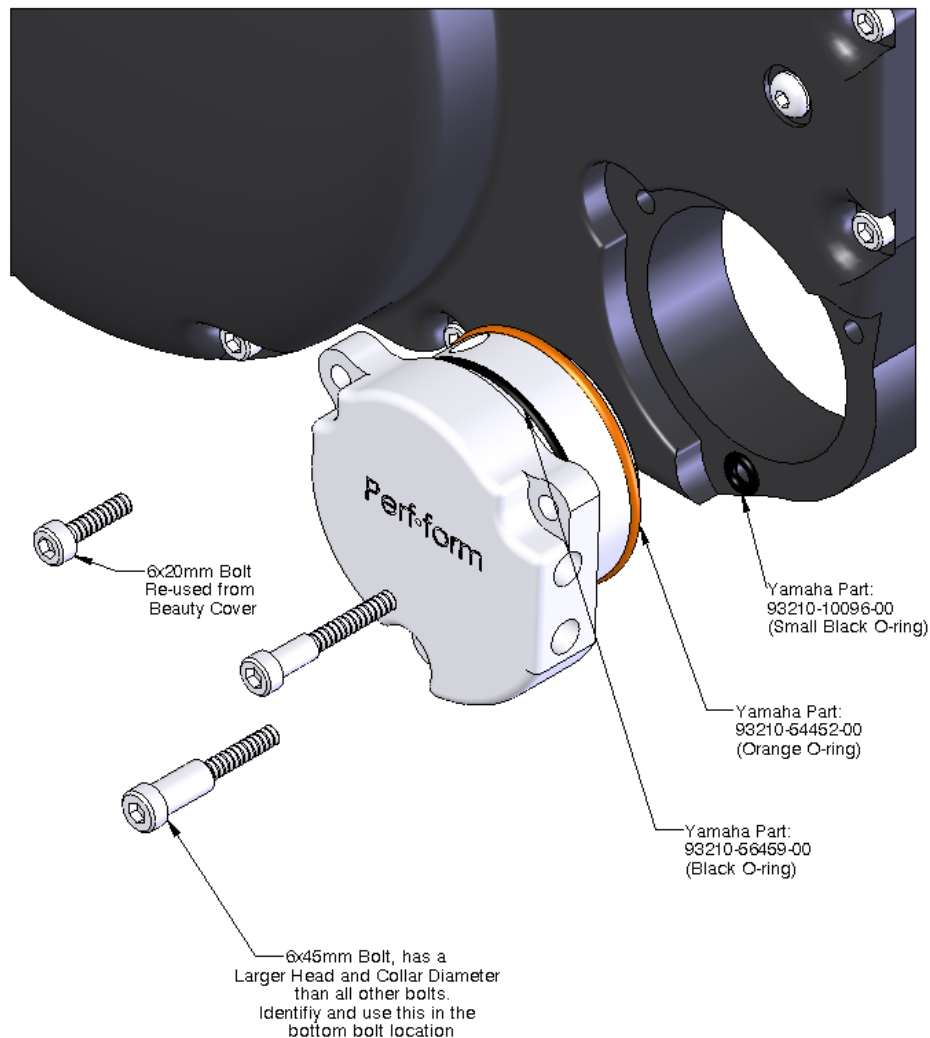

## Bolt & O-Ring Locations

8. Install the **short end** of the spud into the remote filter housing. Do not use thread compound for this step. Use a 3/8" ratchet to tighten.
9. Install fittings into the Oil Filter Housing/mount. Use thread compound on **all** 1/8 NPT oil line fitting threads.
  - a. Install the 45° Elbow into the "input from engine" port of the remote filter mount as shown below. Position the opening of the fitting to face inward and down slightly to the remote filter housing.
  - b. Install a compression fitting into the "output to engine" of remote filter housing. (not shown)
  - c. Install a compression fitting into the 45° NPT fitting previously installed. (not shown)
10. Thread oil lines onto compression fittings, do not tighten.
11. Install the compression fittings into both ports of the engine filter plate adapter. Use thread compound on the 1/8 NPT side of these fittings.
12. Route each oil line between the frame and the brake fluid reservoir and slightly thread the swivel from each oil line into place as shown below. **Making sure to keep the correct orientation of the oil lines.**
13. The stainless lines allow for flexibility in routing the oil lines. Adjust the routing so there is adequate clearance from the exhaust and angle chosen for the remote filter housing when mounted on the frame. Before tightening compression fittings, position the remote filter housing on the frame and adjust the routing of the lines to your preference. After choosing a routing option for the oil lines, tighten all compression fittings and oil filter mount screws.

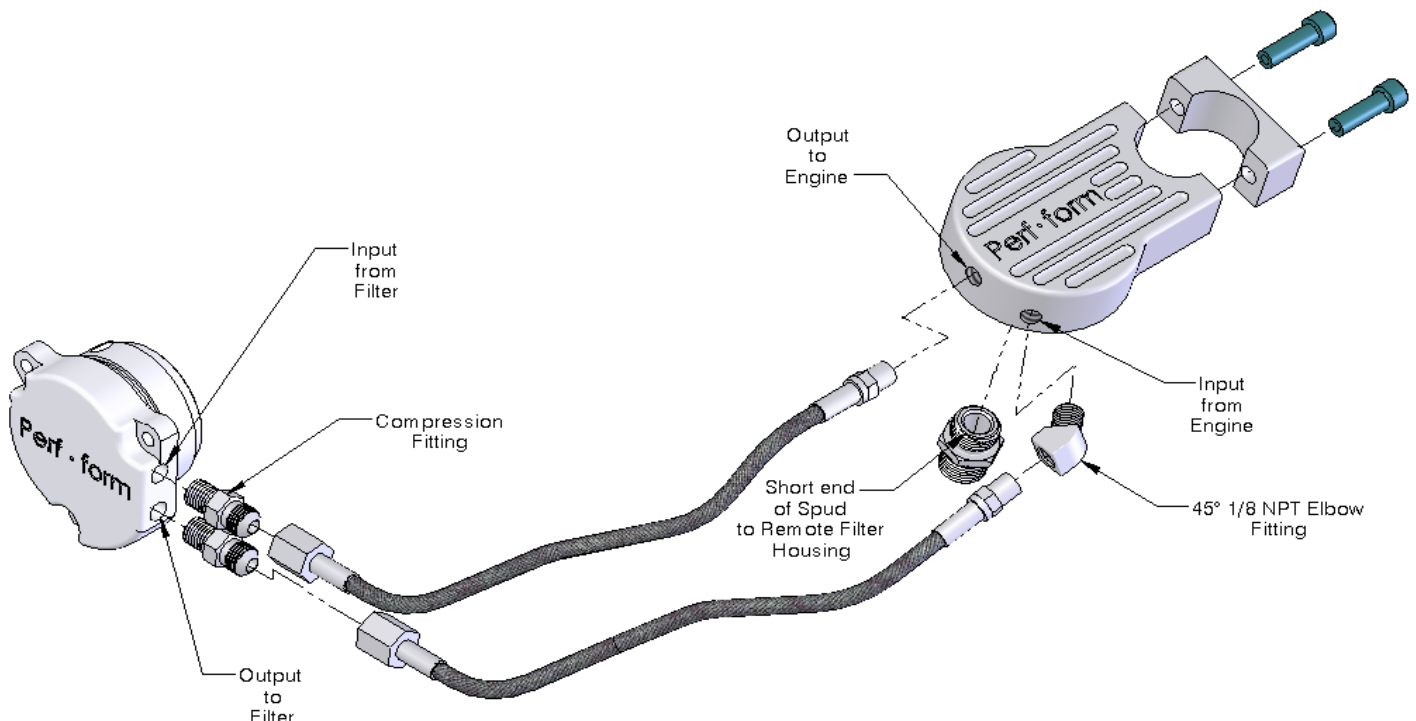

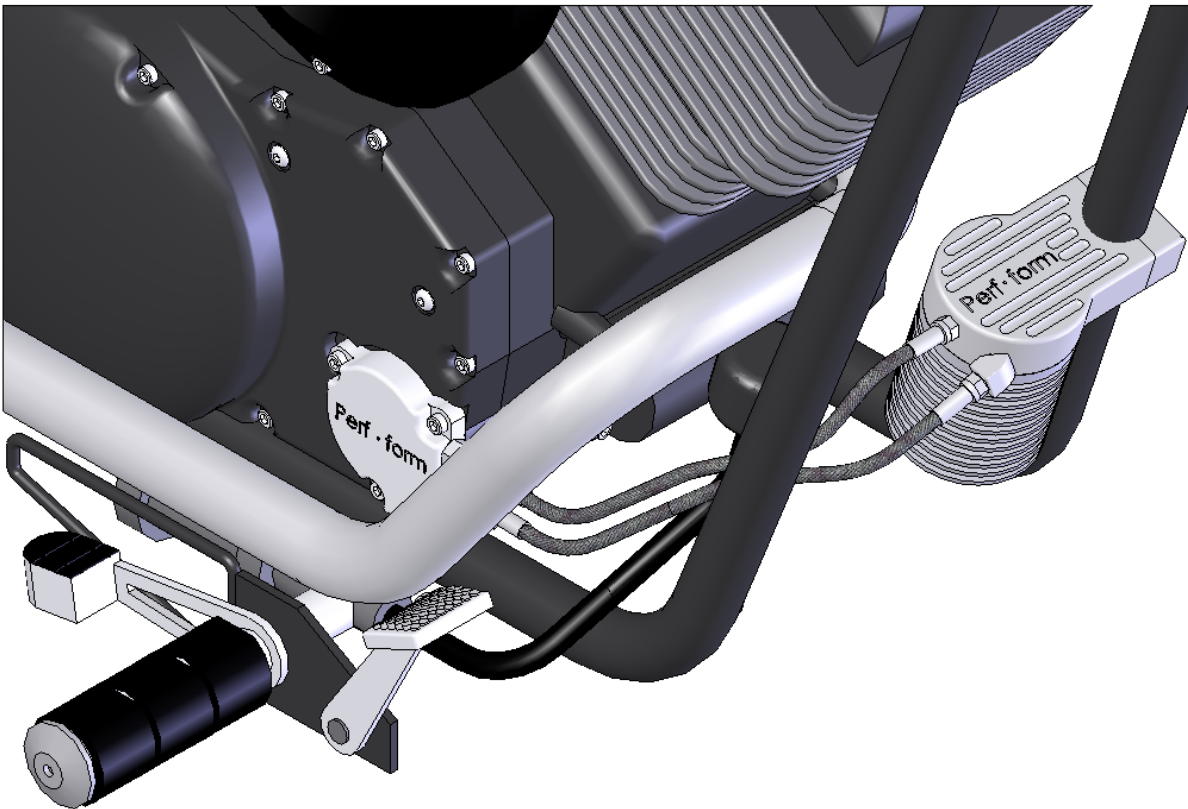

14. Re-Install the exhaust, brake and foot peg assembly.
15. Install either the HD-CXS Oil Filter/Cooler or the HD-5 or HD-5C (Harley Davidson Evolution or Sportster) Oil Filter, as shown below. Pour some oil into the new oil filter and spin onto the spud 3/4 of a turn past hand tight. The HD-CXS Oil Filter/Cooler will cool the oil temperature up to 25 degrees, while the HD5C will cool the oil up to 15 degrees. Both models of filters shown below are 30%+ larger than the original factory filter.

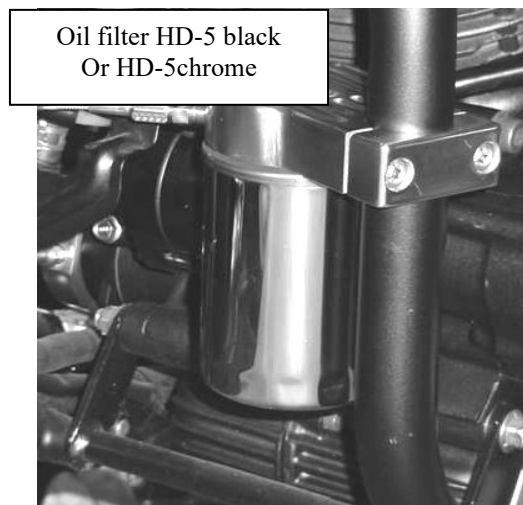
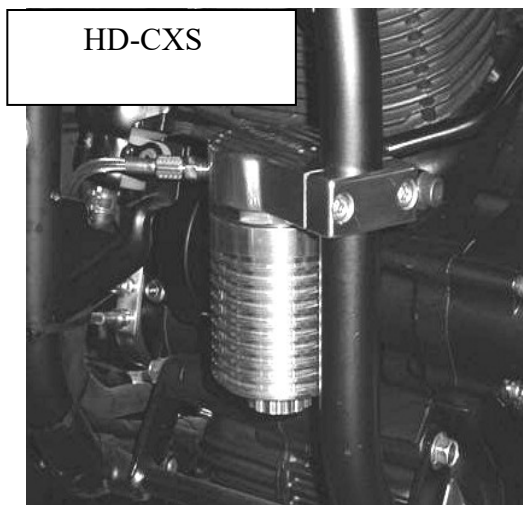



16. If changing your oil at this time, fill the crank case with the recommended amount of oil. Check the oil level after filling. Oil capacity will be increased up to 4-8 oz. Add oil accordingly to compensate for the new oil filter/cooler configuration.
17. Start the engine and check for oil leaks around the filter plate adapter, oil lines and remote filter housing. Take a short test run on the bike and check for leaks again.



### **ONE YEAR LIMITED WARRANTY**

For the period of one year from purchase date, Perf-Form Filters will replace for the original purchaser, free of charge, any part or parts, when found, upon examination by Perf-Form, to be defective in material, workmanship, or both.

All transportation cost incurred by the purchaser in submitting the material to Perf-Form for replacement under this warranty must be borne by the purchaser. If Perf-Form determines that the product must be returned to the factory for credit please call 763-314-0870 for return authorization.

Warranty does not apply to parts that have been damaged by accidents, crashes, alteration, abuse, improper lubrication, normal wear, or other causes beyond Perf-Form's control.

B&P Sales LLC, dba Perf-Form Filters  
1236 Edmonson Ave  
Monticello, MN 55362  
(763)314-0870